

## POWERFLOOD 9 – CUSTOM COLOURS - 35W

829-5055-WL POWERFLOOD 9 230V WIRELESS DMX WHITE MIX 2x5° Ø257mm 37W IP66

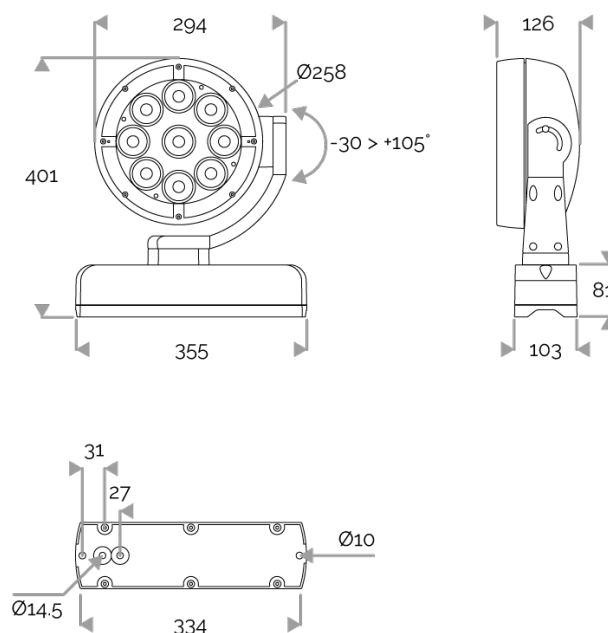

# POWERFLOOD 9 – CUSTOM COLOURS - 35W

829-5055-WL POWERFLOOD 9 230V WIRELESS DMX WHITE MIX 2x5° Ø257mm 37W IP66

## APPLICATION

LED projector for outdoor lighting.  
For use in urban lighting, squares, car parks, architectural accentuation etc...

## LIGHTING FEATURES

CRI70. 36 CUSTOM COLOUR LEDs

## ELECTRICAL FEATURES

230V mains connection. Integrated DMX driver in mounting base and DMX CONNECT SYSTEM plug and socket connectors. Built-in 10 kV/5 kA surge protection. Concealed cable to be specified when ordering.

## CABLES USED

Fixed version: HO7RN-F 3G1,5mm² cable: phase (brown), neutral (blue) & ground (green/yellow).  
DMX version on pole: {3G1,5mm² cable + 2x0,22mm² cable (blue, brown, green/yellow + white(data -) red (data +) + braid)} + 2x0,22mm² cable (white (data -) red (data +) + braid).  
DMX version on wall: CONNECT SYSTEM cable. Length: 50cm.

## MECHANICAL FEATURES

IP66, IK10. Cast aluminium, sandblasted RAL paint to be specified when ordering. Extra-white tempered glass. Silicone gasket. Captive stainless steel fasteners with Delta Seal®. Glare shield comes in raw aluminium with the RAL colour to be specified.  
Extra-white tempered glass. Silicone gasket. Captive stainless steel fasteners with Delta Seal®. Glare shield in raw aluminium, and RAL paint to be defined. Wind pressure = 0,1m². Weight: 11 kg.

## WARRANTY

5-year warranty: on LED module and driver (see the FLUX conditions).



**Lifetime: 60 000 hours L80 B10**

## LUMEN DATA

Lumen nominal total (lm)	4140
Lumen nominal total warm white 2700K (lm)	967,5
Lumen nominal total warm white 3000K (lm)	967,5
Lumen nominal total neutral white 4000K (lm)	1102,5
Lumen nominal total cold white 6500K (lm)	1102,5
lm/W LED total	111,6
lm/W LED warm white 2700K	104,4
lm/W LED warm white 3000K	104,4
lm/W LED neutral white 4000K	118,9
lm/W LED cold white 6500K	118,9
Qty LED	36
Ta max.	30°C
Tj (at 25°C)	85°C

## INRUSH CURRENT

Inrush Current (A)	55
Inrush Current Time (µs)	270

## POWER

Product Led Power (W)	37,1
Product Power (W)	45,3

