

POWERFLOOD 9 - 230V - Monochrome - 39W - 5370 lm **829-3215-HT POWERFLOOD 9 230V fixed 2700K 2x17° Ø257mm 28W IP66**

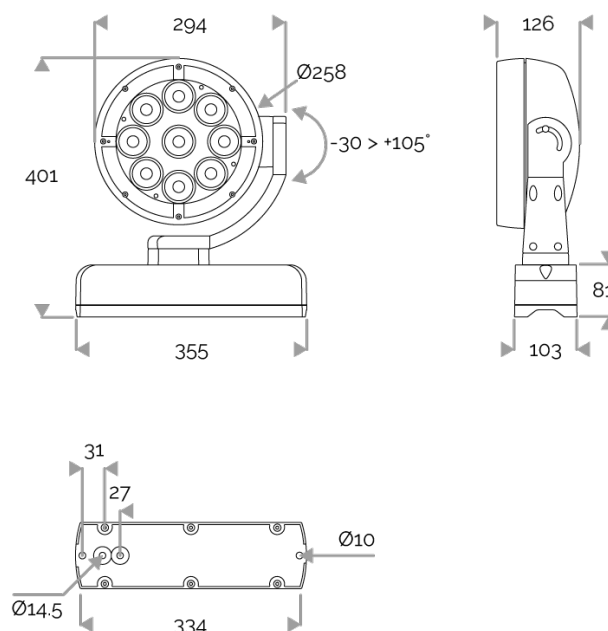

APPLICATION

Monochrome LED projector for outdoor lighting.
 For use in urban lighting, squares, car parks, architectural accentuation etc...

LIGHTING FEATURES

CRI70. 9 LEDs monochrome.

ELECTRICAL FEATURES

230V mains connection. Integrated driver in mounting base. Built-in 10 kV/5 kA surge protection.
 Concealed cable to be specified when ordering.

MECHANICAL FEATURES

IP66, IK10. Cast aluminium, sandblasted RAL paint to be specified when ordering. Extra-white tempered glass. Silicone gasket. Captive stainless steel fasteners with Delta Seal®. Glare shield comes in raw aluminium with the RAL colour to be specified. Wind pressure = 0,1m². Weight: 11 kg.

WARRANTY

5-year warranty: on LED module and driver (see the FLUX conditions).



Lifetime: 60 000 hours L80 B10

LUMEN DATA

| | |
|-------------------------------------------|-------|
| Lumen nominal total warm white 2700K (lm) | 3456 |
| lm/W LED warm white 2700K | 122,7 |
| lm/W product warm white 2700K | 98,7 |
| Qty LED | 9 |
| Ta max. | 50°C |
| Tj (at 25°C) | 85°C |

INRUSH CURRENT

| | |
|--------------------------|-----|
| Inrush Current (A) | 60 |
| Inrush Current Time (µs) | 210 |

POWER

| | |
|-----------------------|------|
| Product Led Power (W) | 28,2 |
| Product Power (W) | 35 |

