

## POWERFLOOD 9 - 230V - Monochrome - 39W - 5370 lm

829-0495 POWERFLOOD 9 230V fixed 4000K 2x5° Ø257mm 38W IP66

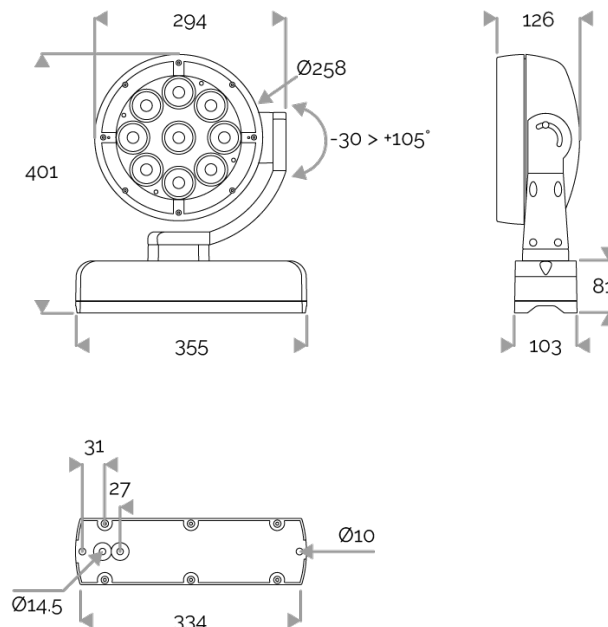

### APPLICATION

Monochrome LED projector for outdoor lighting.  
For use in urban lighting, squares, car parks, architectural accentuation etc...

### LIGHTING FEATURES

CRI70. 9 LEDs monochrome.

### ELECTRICAL FEATURES

230V mains connection. Integrated driver in mounting base. Built-in 10 kV/5 kA surge protection.  
Concealed cable to be specified when ordering.

### MECHANICAL FEATURES

IP66, IK10. Cast aluminium, sandblasted RAL paint to be specified when ordering. Extra-white tempered glass. Silicone gasket. Captive stainless steel fasteners with Delta Seal®. Glare shield comes in raw aluminium with the RAL colour to be specified. Wind pressure = 0,1m². Weight: 11 kg.

### WARRANTY

5-year warranty: on LED module and driver (see the FLUX conditions).



**Lifetime: 60 000 hours L80 B10**

### LUMEN DATA

Lumen nominal total neutral white 4000K (lm)	5373
lm/W LED neutral white 4000K	139,2
lm/W product neutral white 4000K	116,3
Qty LED	9
Ta max.	30°C
Tj (at 25°C)	85°C

### INRUSH CURRENT

Inrush Current (A)	60
Inrush Current Time (µs)	210

### POWER

Product Led Power (W)	38,6
Product Power (W)	46,2