

# **POWERFLOOD 9 - 230V - Monochrome - 39W - 5370 lm** **829-0045 POWERFLOOD 9 230V fixed 3000K 2x3,7° Ø257mm 38W IP66**

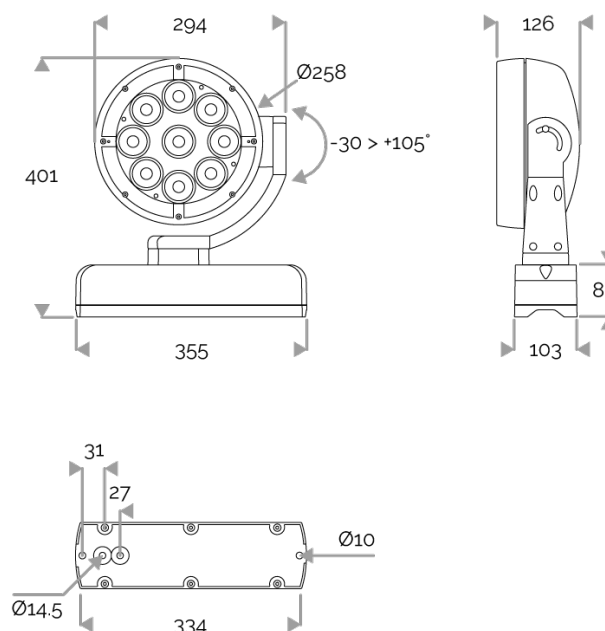

## **APPLICATION**

Monochrome LED projector for outdoor lighting.  
 For use in urban lighting, squares, car parks, architectural accentuation etc...

## **LIGHTING FEATURES**

CRI70. 9 LEDs monochrome.

## **ELECTRICAL FEATURES**

230V mains connection. Integrated driver in mounting base. Built-in 10 kV/5 kA surge protection.  
 Concealed cable to be specified when ordering.

## **MECHANICAL FEATURES**

IP66, IK10. Cast aluminium, sandblasted RAL paint to be specified when ordering. Extra-white tempered glass. Silicone gasket. Captive stainless steel fasteners with Delta Seal®. Glare shield comes in raw aluminium with the RAL colour to be specified. Wind pressure = 0,1m². Weight: 11 kg.

## **WARRANTY**

5-year warranty: on LED module and driver (see the FLUX conditions).



**Lifetime: 60 000 hours L80 B10**

## **LUMEN DATA**

Lumen nominal total warm white 3000K (lm)	4653
lm/W LED warm white 3000K	120,5
lm/W product warm white 3000K	100,7
Qty LED	9
Ta max.	30°C
Tj (at 25°C)	85°C

## **INRUSH CURRENT**

Inrush Current (A)	60
Inrush Current Time (µs)	210

## **POWER**

Product Led Power (W)	38,6
Product Power (W)	46,2

