

## POWERFLOOD 9 – CUSTOM COLOURS - 35W

829-5030-WL-HT POWERFLOOD 9 230V WIRELESS DMX RGB-4000K 2x5° Ø257mm 25W IP66

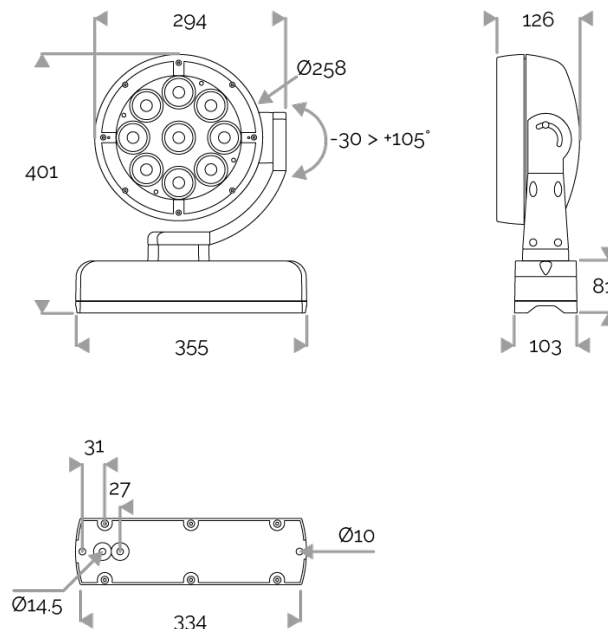

# POWERFLOOD 9 – CUSTOM COLOURS - 35W

829-5030-WL-HT POWERFLOOD 9 230V WIRELESS DMX RGB-4000K 2x5° Ø257mm 25W IP66

## APPLICATION

LED projector for outdoor lighting.  
For use in urban lighting, squares, car parks, architectural accentuation etc...

## LIGHTING FEATURES

CRI70. 36 CUSTOM COLOUR LEDs

## ELECTRICAL FEATURES

230V mains connection. Integrated DMX driver in mounting base and DMX CONNECT SYSTEM plug and socket connectors. Built-in 10 kV/5 kA surge protection. Concealed cable to be specified when ordering.

## CABLES USED

Fixed version: HO7RN-F 3G1,5mm² cable: phase (brown), neutral (blue) & ground (green/yellow).  
DMX version on pole: {3G1,5mm² cable + 2x0,22mm² cable (blue, brown, green/yellow + white(data -) red (data +) + braid)} + 2x0,22mm² cable (white (data -) red (data +) + braid).  
DMX version on wall: CONNECT SYSTEM cable. Length: 50cm.

## MECHANICAL FEATURES

IP66, IK10. Cast aluminium, sandblasted RAL paint to be specified when ordering. Extra-white tempered glass. Silicone gasket. Captive stainless steel fasteners with Delta Seal®. Glare shield comes in raw aluminium with the RAL colour to be specified.  
Extra-white tempered glass. Silicone gasket. Captive stainless steel fasteners with Delta Seal®. Glare shield in raw aluminium, and RAL paint to be defined. Wind pressure = 0,1m². Weight: 11 kg.

## WARRANTY

5-year warranty: on LED module and driver (see the FLUX conditions).



**Lifetime: 60 000 hours L80 B10**

## LUMEN DATA

Lumen nominal total neutral white 4000K (lm)	851,4
Lumen nominal total red (lm)	299,7
Lumen nominal total green (lm)	671,4
Lumen nominal total royal blue (mW)	3613,5
lm/W LED neutral white 4000K	126,1
lm/W LED red	62,8
lm/W LED green	96,9
mW/W LED royal blue	535,3
Qty LED	36
Ta max.	50°C
Tj (at 25°C)	85°C

## INRUSH CURRENT

Inrush Current (A)	55
Inrush Current Time (µs)	270

## POWER

Product Led Power (W)	25,2
Product Power (W)	33,5

