

POWERFLOOD 9 – CUSTOM COLOURS - 35W

829-0305-HT POWERFLOOD 9 230V DMX RGBW 2x11° Ø257mm 24W IP66

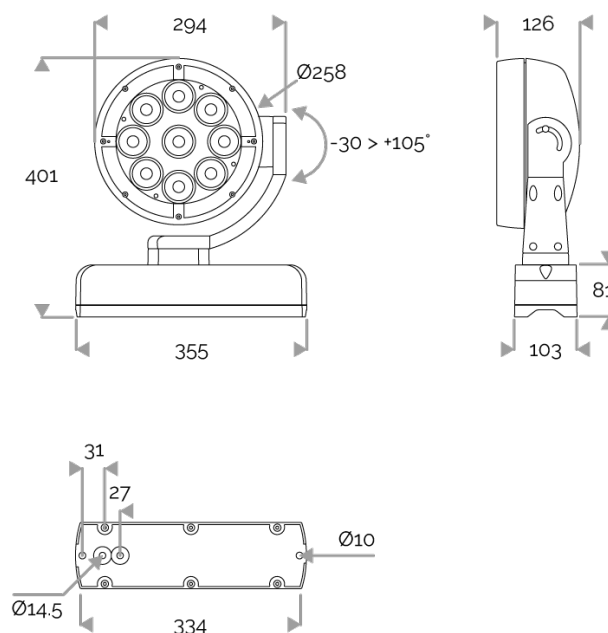

POWERFLOOD 9 – CUSTOM COLOURS - 35W

829-0305-HT POWERFLOOD 9 230V DMX RGBW 2x11° Ø257mm 24W IP66

APPLICATION

LED projector for outdoor lighting.
For use in urban lighting, squares, car parks, architectural accentuation etc...

LIGHTING FEATURES

CRI70. 36 CUSTOM COLOUR LEDs

ELECTRICAL FEATURES

230V mains connection. Integrated DMX driver in mounting base and DMX CONNECT SYSTEM plug and socket connectors. Built-in 10 kV/5 kA surge protection. Concealed cable to be specified when ordering.

CABLES USED

Fixed version: HO7RN-F 3G1,5mm² cable: phase (brown), neutral (blue) & ground (green/yellow).
DMX version on pole: {3G1,5mm² cable + 2x0,22mm² cable (blue, brown, green/yellow + white(data -) red (data +) + braid)} + 2x0,22mm² cable (white (data -) red (data +) + braid).
DMX version on wall: CONNECT SYSTEM cable. Length: 50cm.

MECHANICAL FEATURES

IP66, IK10. Cast aluminium, sandblasted RAL paint to be specified when ordering. Extra-white tempered glass. Silicone gasket. Captive stainless steel fasteners with Delta Seal®. Glare shield comes in raw aluminium with the RAL colour to be specified.
Extra-white tempered glass. Silicone gasket. Captive stainless steel fasteners with Delta Seal®. Glare shield in raw aluminium, and RAL paint to be defined. Wind pressure = 0,1m². Weight: 11 kg.

WARRANTY

5-year warranty: on LED module and driver (see the FLUX conditions).



Lifetime: 60 000 hours L80 B10

LUMEN DATA

Lumen nominal total neutral white 4000K (lm)	514,8
Lumen nominal total red (lm)	269,1
Lumen nominal total green (lm)	624,6
Lumen nominal total blue (lm)	106,2
lm/W LED neutral white 4000K	80,6
lm/W LED red	57,5
lm/W LED green	95,1
lm/W LED blue	16,6
Qty LED	9
Ta max.	50°C
Tj (at 25°C)	85°C

INRUSH CURRENT

Inrush Current (A)	55
Inrush Current Time (µs)	270

POWER

Product Led Power (W)	24
Product Power (W)	33,5