

**POWERFLOOD 9 - 230V - Monochrome - 39W - 5370 lm**  
829-3025-HT POWERFLOOD 9 230V fixed green 2x5° Ø257mm 28W IP66

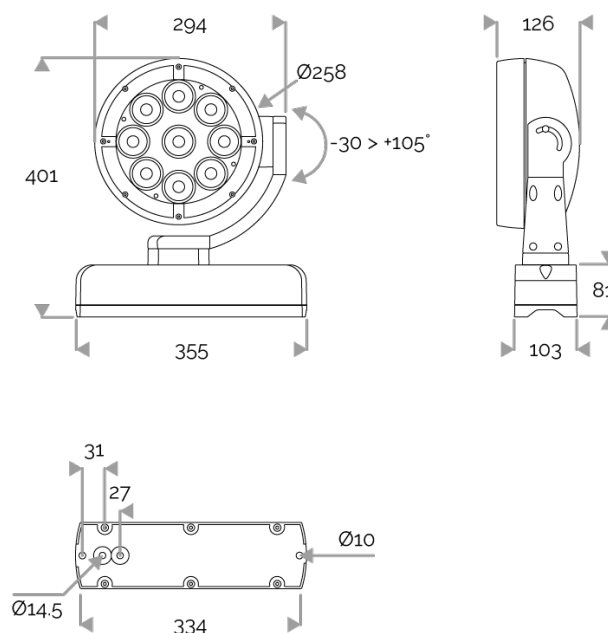

**APPLICATION**

Monochrome LED projector for outdoor lighting.  
For use in urban lighting, squares, car parks, architectural accentuation etc...

**LIGHTING FEATURES**

CRI70. 9 LEDs monochrome.

**ELECTRICAL FEATURES**

230V mains connection. Integrated driver in mounting base. Built-in 10 kV/5 kA surge protection.  
Concealed cable to be specified when ordering.

**MECHANICAL FEATURES**

IP66, IK10. Cast aluminium, sandblasted RAL paint to be specified when ordering. Extra-white tempered glass. Silicone gasket. Captive stainless steel fasteners with Delta Seal®. Glare shield comes in raw aluminium with the RAL colour to be specified. Wind pressure = 0,1m². Weight: 11 kg.

**WARRANTY**

5-year warranty: on LED module and driver (see the FLUX conditions).



**Lifetime: 60 000 hours L80 B10**

**LUMEN DATA**

Lumen nominal total green (lm)	2685,6
lm/W LED green	96,9
lm/W product green	68,2
Qty LED	36
Ta max.	50°C
Tj (at 25°C)	85°C

**INRUSH CURRENT**

Inrush Current (A)	60
Inrush Current Time (µs)	210

**POWER**

Product Led Power (W)	27,7
Product Power (W)	39,4

