

POWERFLOOD 9 - 230V - Monochrome - 39W - 5370 lm

829-3035 POWERFLOOD 9 230V fixed green 2x17° Ø257mm 38W IP66

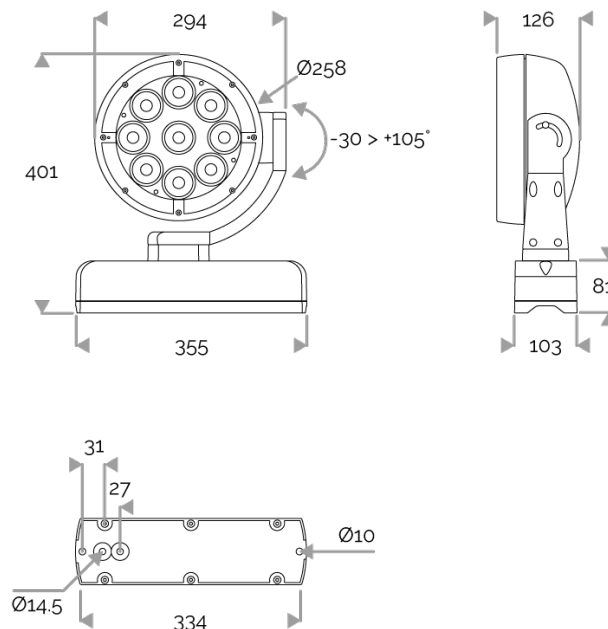

APPLICATION

Monochrome LED projector for outdoor lighting.
For use in urban lighting, squares, car parks, architectural accentuation etc...

LIGHTING FEATURES

CRI70. 9 LEDs monochrome.

ELECTRICAL FEATURES

230V mains connection. Integrated driver in mounting base. Built-in 10 kV/5 kA surge protection.
Concealed cable to be specified when ordering.

MECHANICAL FEATURES

IP66, IK10. Cast aluminium, sandblasted RAL paint to be specified when ordering. Extra-white tempered glass. Silicone gasket. Captive stainless steel fasteners with Delta Seal®. Glare shield comes in raw aluminium with the RAL colour to be specified. Wind pressure = 0,1m². Weight: 11 kg.

WARRANTY

5-year warranty: on LED module and driver (see the FLUX conditions).



Lifetime: 60 000 hours L80 B10

LUMEN DATA

Lumen nominal total green (lm)	3391,2
lm/W LED green	88,9
lm/W product green	66,2
Qty LED	36
Ta max.	30°C
Tj (at 25°C)	85°C

INRUSH CURRENT

Inrush Current (A)	60
Inrush Current Time (µs)	210

POWER

Product Led Power (W)	38,2
Product Power (W)	51,2

